

mPrep/s™ WorkStation for TEM and SEM

Catalog #85010-06

Quick Start Guide – Oriented Specimens

1. Transfer screen from capsule to workstation.

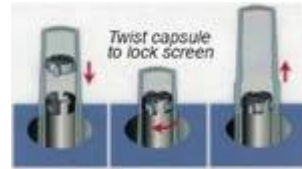

2. Load and orient specimen

A. Compression Method

1. Orient on the closed screen
2. Insert capsule
3. Gently compress specimen
4. Remove loaded capsule
5. Twist capsule to release screen

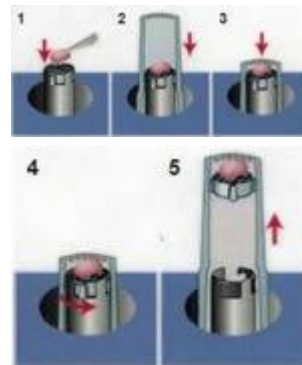

B. Pinch Method

1. Push lever to open slot in screen
2. Insert specimen into slot
3. Release lever to close slot
4. Insert capsule
5. Twist capsule to release screen
6. Remove loaded capsule

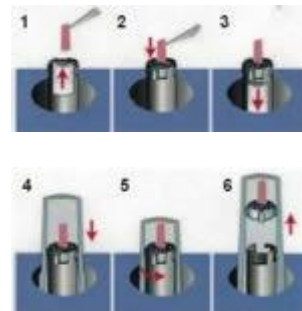

3. Label capsule and process specimen

Specimen Label

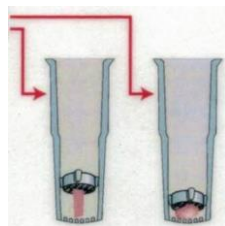

Apply Label

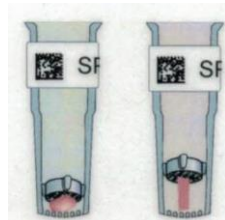

Attach Pipettor and Process

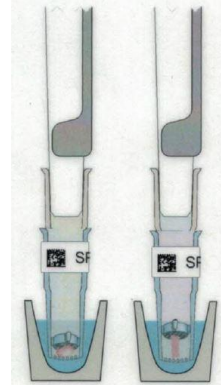

Product Information

[mPrep/s™ WorkStation for TEM and SEM](#)